

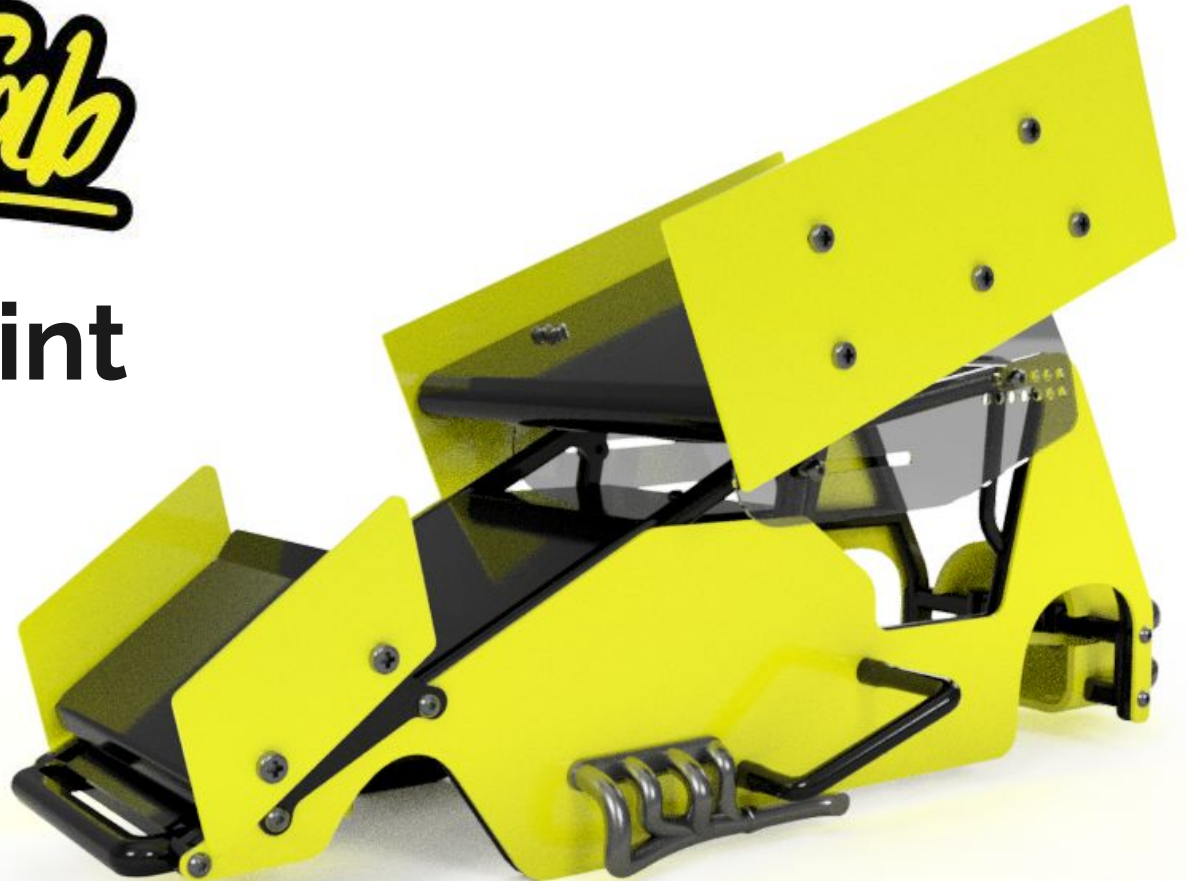

Mini-B Sprint Car Cage



Hardware

1 - 4-40x3/8" Countersink Screw

4 - M2 x 12 Cap Head Screws

4 - M2.5 x 4 Button Head Screws
(included with optional headers)

10 - M2.5 x 6 Button Head Screws

18 - M2.5 x 8 Button Head Screws

3 - M2.5 x 10 Button Head Screws

8 - M2.5 x 12 Button Head Screws

1

Note: Build the Left and Right Side

M2.5 x 4

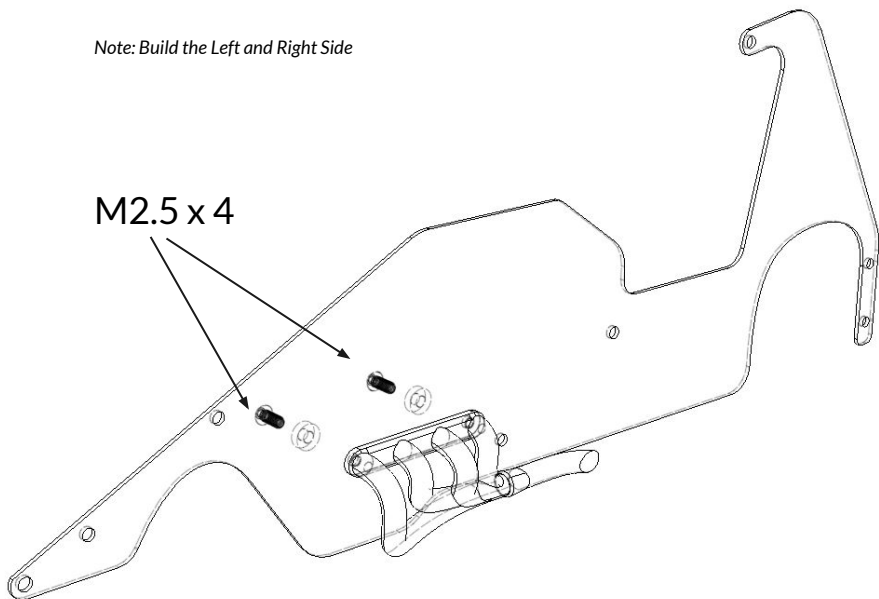

Attach the headers to both side panels with 2 - m2.5x4 BHS from the inside of the side panel.

2

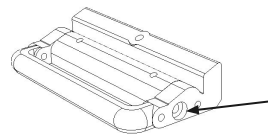

Use 2 - M2.5 x 8 to secure the front brace to the body hinge mount. **DO NOT OVER TIGHTEN**

Note: Only attach the cross braces to the Drivers side in this step.

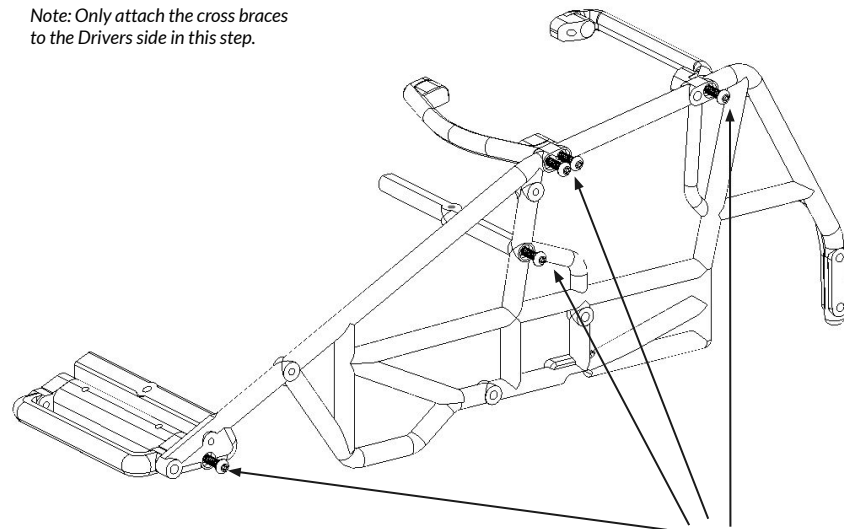

M2.5 x 8

Attach the cross braces with 5 - M2.5 x 8 BHS

3

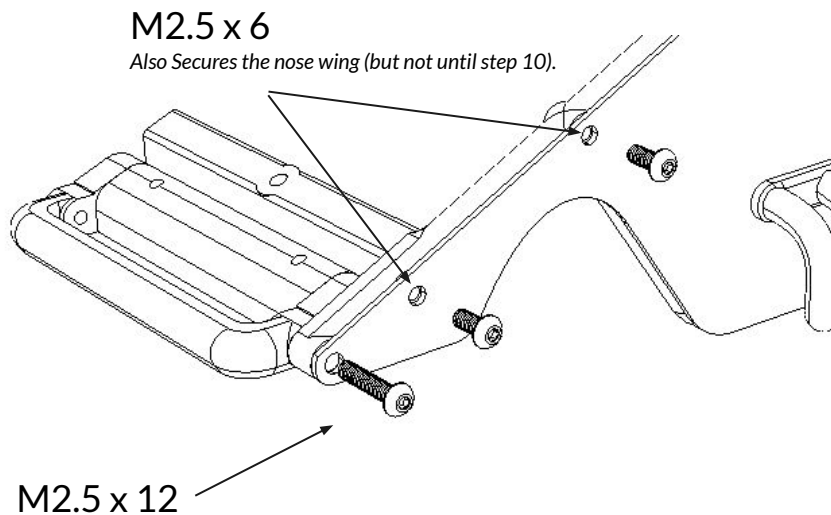

Attach the body panel to the side of the chassis starting in the front. The first m2.5x12 BHS goes into the nose and the front brace. The next two m2.5x6 BHS will also be used to hold the nose wing in place in Step 10.

4

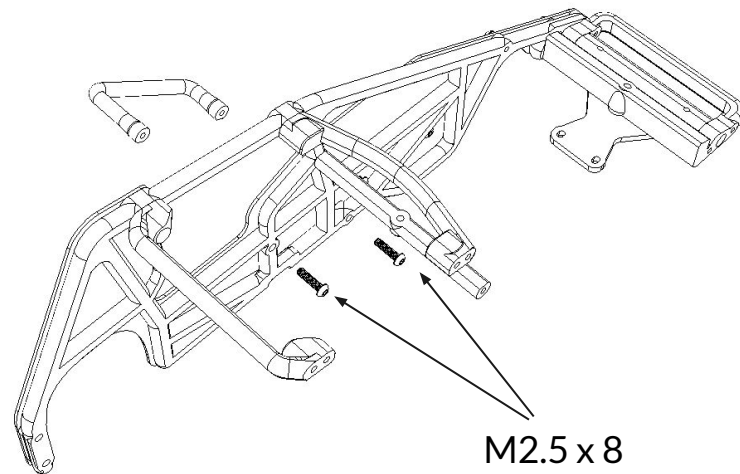

Attach the nerf bar from the inside of the cage, through the body panel with 2 - m2.5x8 BHS,

5

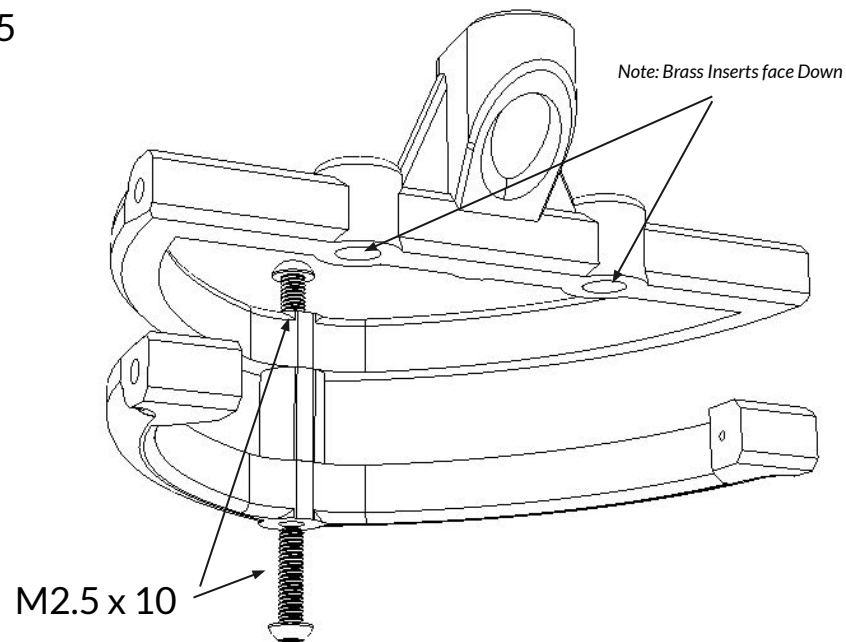

Use the supplied spacer and 2 - m2.5x10 BHS to assemble the tail tank cage. Make sure the brass inserts on the cage are facing down toward the lower cage.

6

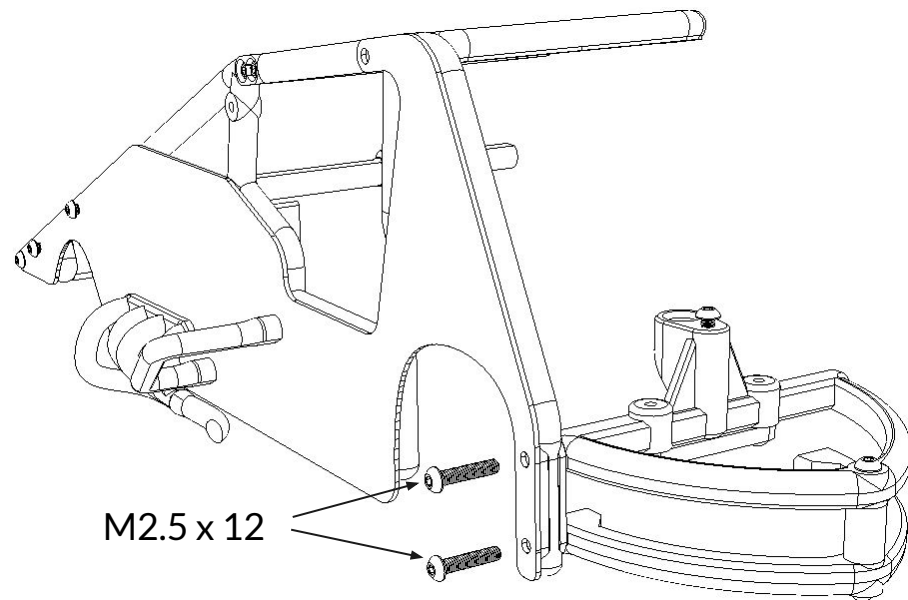

Use 2 - m2.5x12 BHS to fix the tail tank cage to the main cage. Make sure the brass inserts on the cage are facing down.

7

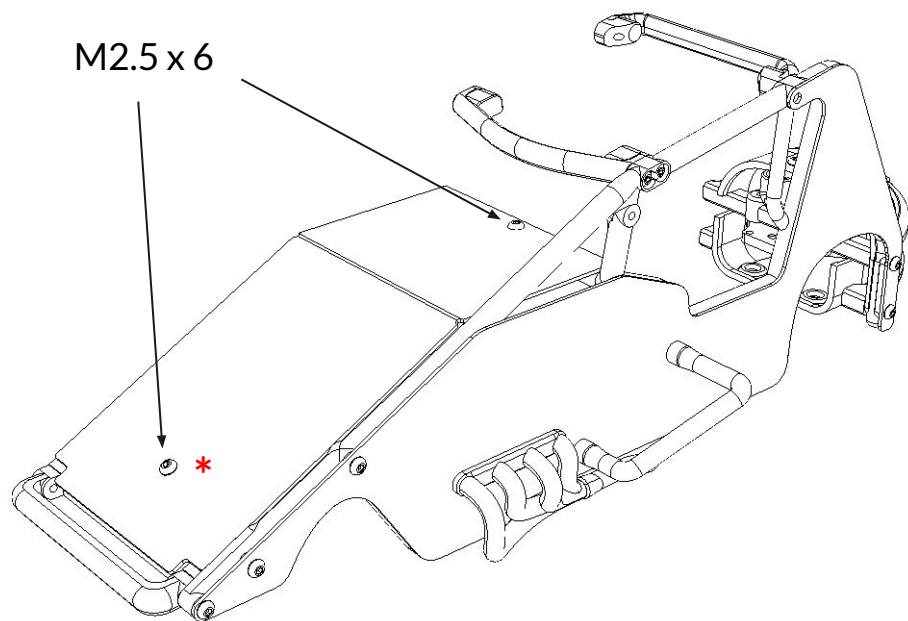

**Rev A cages will use a m3x6 screw here*

8

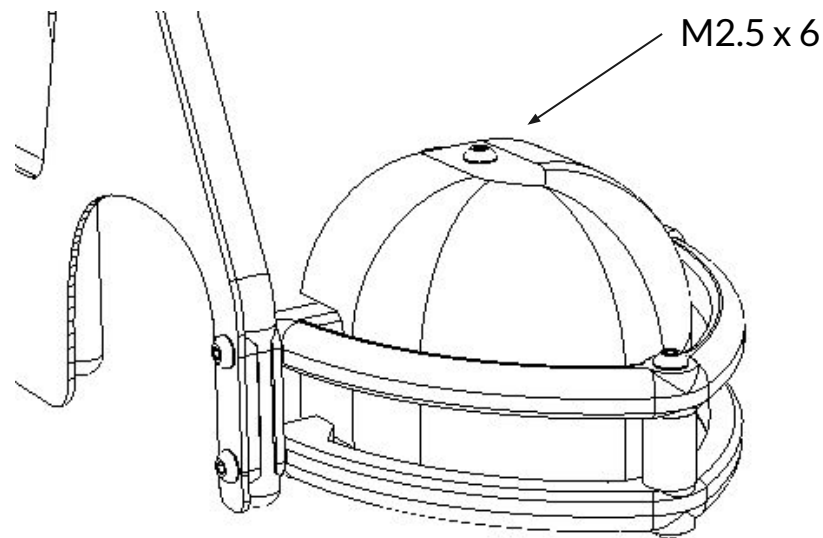

Attach the hood and tail tank with the supplied 2 - m2.5x6 BHS. Insert the tail tank from the top with the recess around the cross brace. Then rotate the tail tank down into place.

To use a rigid rear mount, use 2 - M2.5 x 8 to secure the rear of the cage.

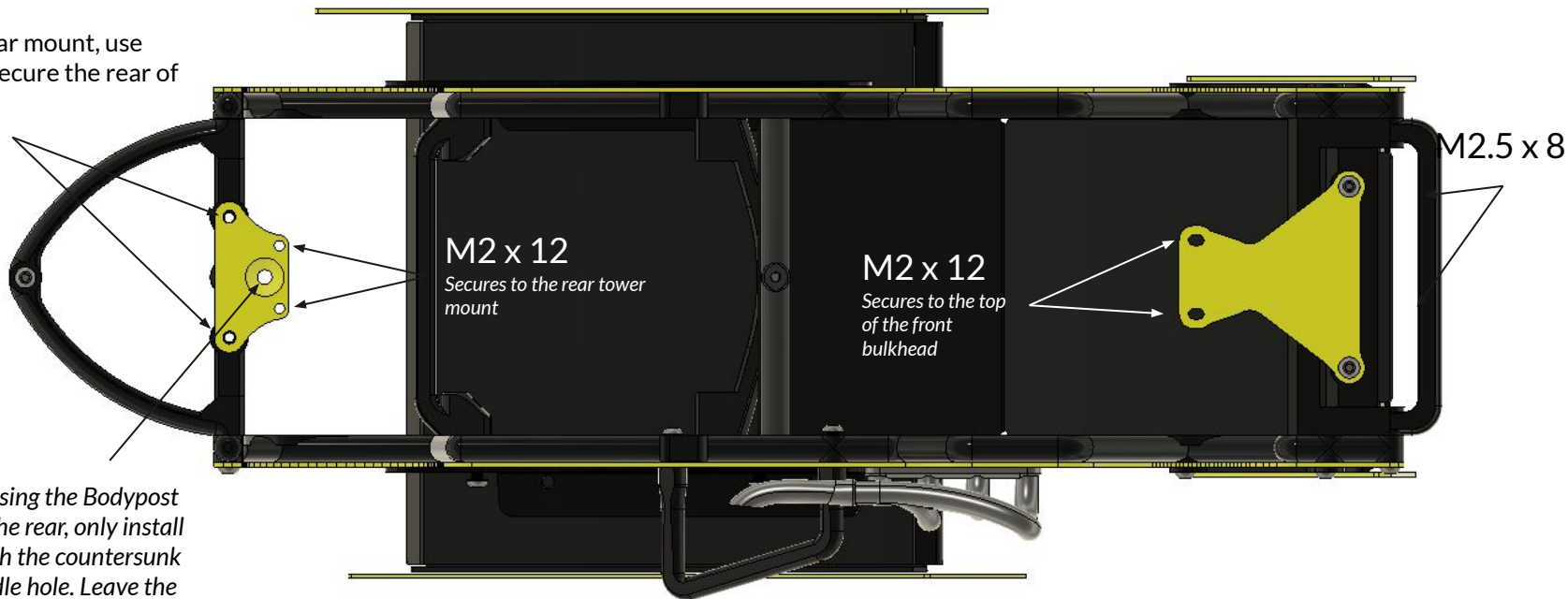

Note: If you are using the Bodypost quick release in the rear, only install the Bodypost with the countersunk screw in the middle hole. Leave the M2.5x8's out.

The car uses the two supplied adapter plates (pictured in yellow) to secure the car to the chassis. Fix the inner most holes with the supplied 4 - M2x12s. In the rear, remove the rear most shock tower screws. Secure the rear brace with 2 - m2 x 12. In the front, remove the screws from the top that go down through the bulkhead and secure the front plate with 2 - M2x12s (Do Not Over Tighten). The adapter plates are then secured to the cage from the bottom with 4 - m2.5x8's into the brass threaded inserts.

10

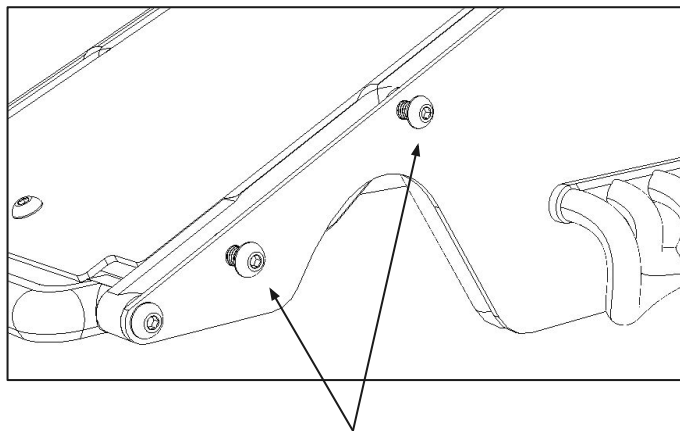

The hood wing attaches to the two front M2 - m2.5x6 BHS.

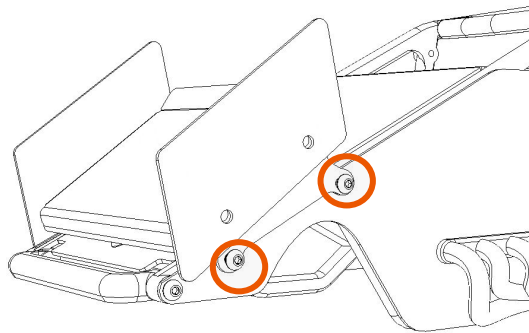

11

M2.5 x 6

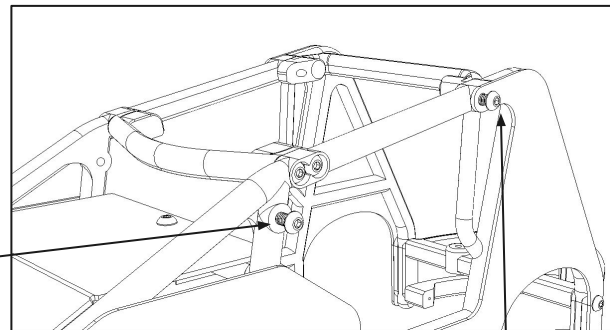

The roof wing attaches to one rear M2.5x12 at the rear upper cage brace and on the a pillar with one M2.5 - m2.5x6.

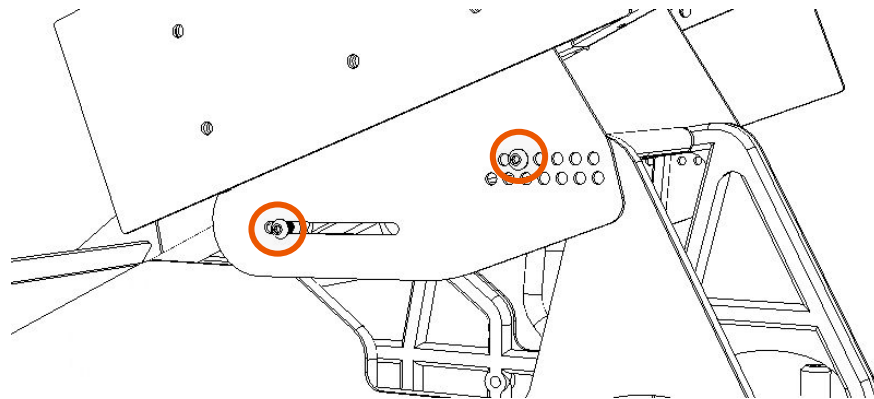

12 Assemble the main wing with the provided Nylon Screws.

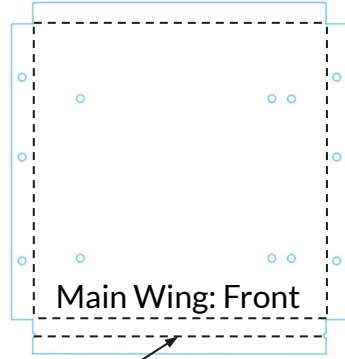

Dotted lines indicate bends. Front and Sides Bend Down. The Rear Bends Up

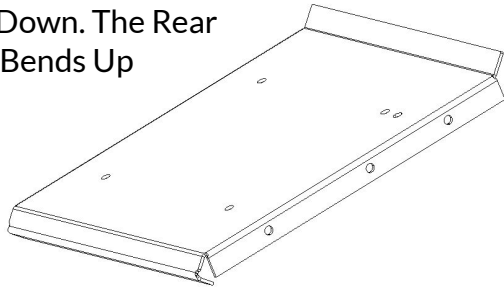

Wing Uprights



"Drivers" Side



"Passengers" Side

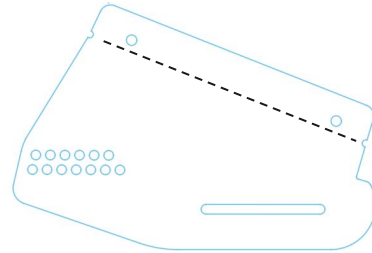

Bends on both wing supports bend at 90 degrees towards the "Drivers Side"

Wing Brace x 2

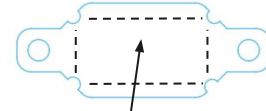

Dotted lines indicate bends. All bend upwards at a 45 Degree Angle

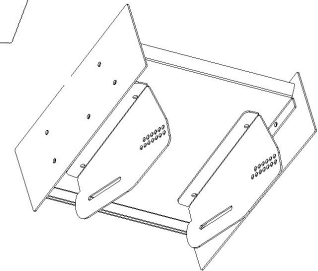
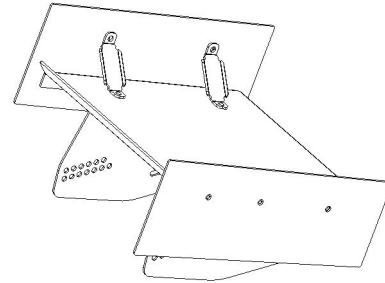

13 Assemble the nose wing with the provided Nylon Screws.

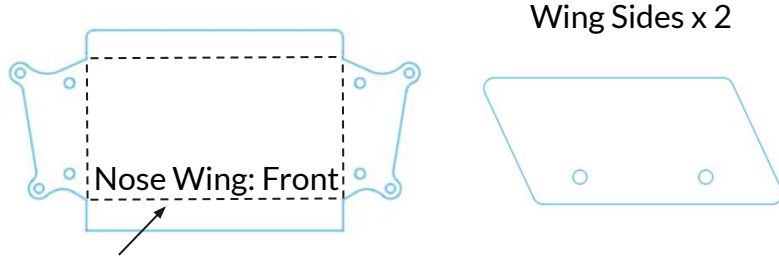

Dotted lines indicate bends.
Front and Sides Bend Down.
The Rear Bends Up

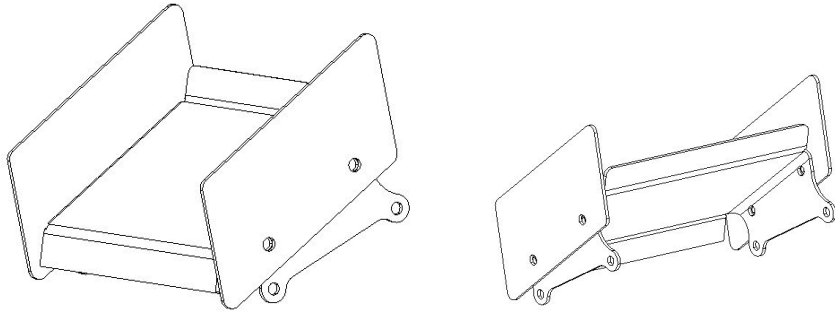

Trimming the Tail Tank

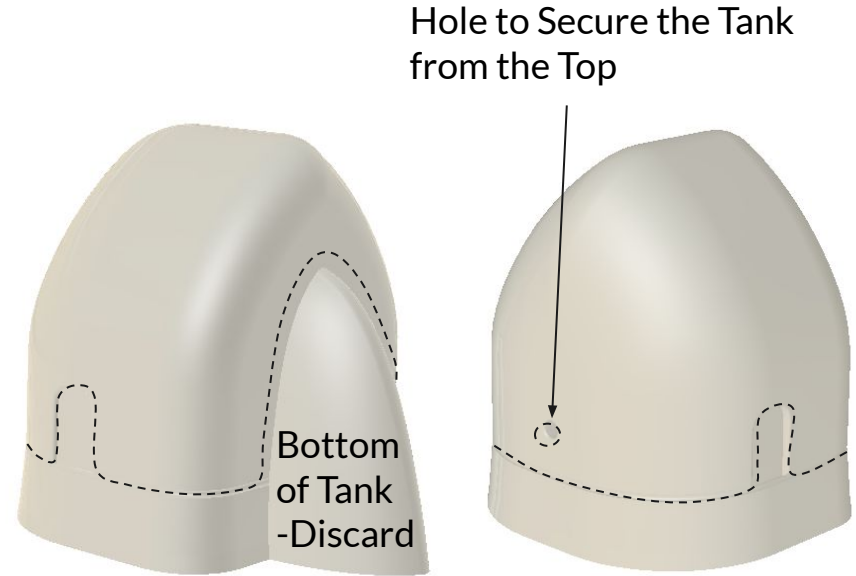

Additional Information

